

## Socket Allen Screw

**Head Style:** Button Head

**Drive Type:** Internal Hex

**Thread Type:** Metric - Coarse

**Material:** Alloy Steel Heat Treated

**Class Grade:** High Tensile Class 12.9

**Finish:** Zinc Plated

**Corrosion Protection Level:** Moderate

**Standard:** ISO 7380

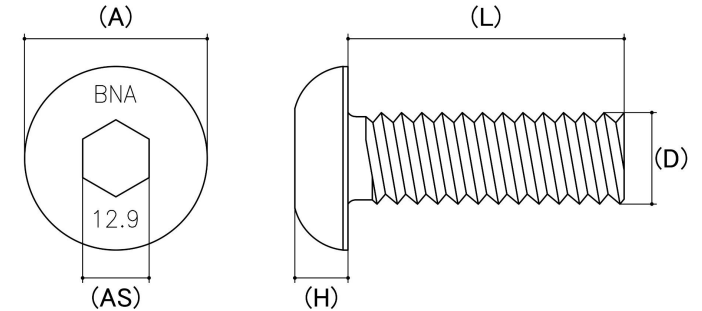

*Cad Drawings shown for graphic representation only.\**

| Size | Thread Pitch (mm) | Thread Type | Product Diameter (D) (mm) |       | Head Diameter (A) (mm) |       | Head Height (H) (mm) |      | Driver Bit Size (AS) (mm) | sku (Part Number) |
|------|-------------------|-------------|---------------------------|-------|------------------------|-------|----------------------|------|---------------------------|-------------------|
|      |                   |             | Min                       | Max   | Min                    | Max   | Min                  | Max  |                           |                   |
| M3   | 0.50mm            | Coarse      | 2.87                      | 2.98  | 5.40                   | 5.70  | 1.43                 | 1.65 | 2                         | 31B3              |
| M4   | 0.70mm            | Coarse      | 3.83                      | 3.97  | 7.24                   | 7.60  | 1.95                 | 2.20 | 2                         | 31B4              |
| M5   | 0.80mm            | Coarse      | 4.82                      | 5.00  | 9.14                   | 9.50  | 2.50                 | 2.75 | 3                         | 31B5              |
| M6   | 1.00mm            | Coarse      | 5.82                      | 6.00  | 10.07                  | 10.50 | 3.00                 | 3.30 | 4                         | 31B6              |
| M8   | 1.25mm            | Coarse      | 7.78                      | 8.00  | 13.57                  | 14.00 | 4.05                 | 4.40 | 5                         | 31B8              |
| M10  | 1.50mm            | Coarse      | 9.78                      | 10.00 | 17.07                  | 17.50 | 5.20                 | 5.50 | 6                         | 31B10             |
| M12  | 1.75mm            | Coarse      | 11.73                     | 12.00 | 17.07                  | 17.50 | 6.24                 | 6.60 | 8                         | 31B12             |

**Disclaimer:**

Dimensional data and technical information was obtained from publically available sources and not acquired through standard agencies. It has been completed and compiled for reference purposes only; where discrepancies are found they are subject to change without notice. Bolt & Nut Australia makes no warranties or representations regarding the accuracy and validity of the compiled information and data. Contact the relevant standard authorities for accurate and detailed information.

\* Cad Drawings may not reflect diameter, thread length or overall length.

© Bolt & Nut Australia Pty Ltd. All rights reserved.

Version: 29 Aug 2024